



Rejuv-a-Roller™

The way to really clean up!

**Cleans 9" rollers
3/8" to 1-1/2" nap!**
Also cleans any size rollers
between 3" - 9"*

How to use the Rejuv-a-Roller automatic paint roller cleaner

For best results use the Rejuv-a-Roller in the utility sink or outside spigot. These hook-ups provide a higher volume of water for more efficient cleaning.

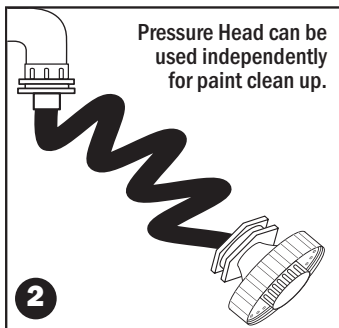
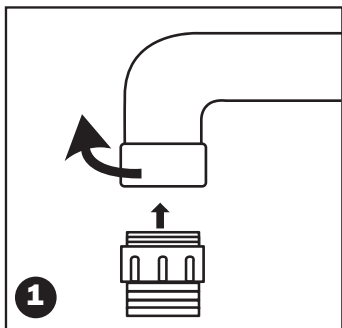

The Rejuv-a-Roller comes with a faucet adapter.

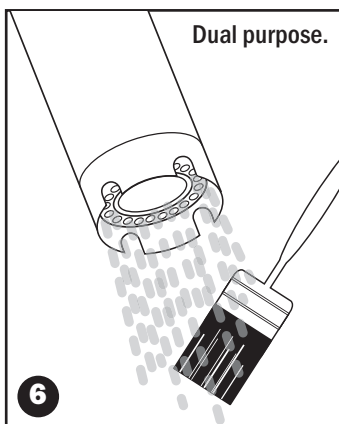
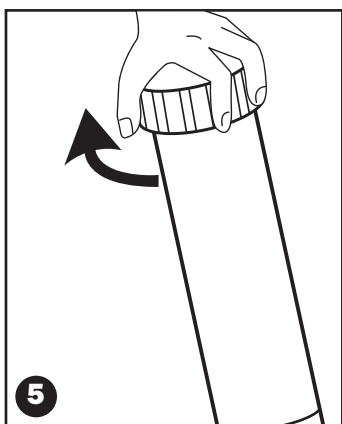
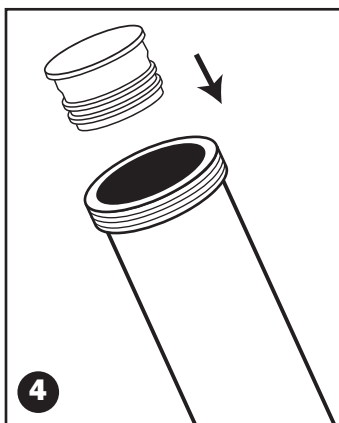
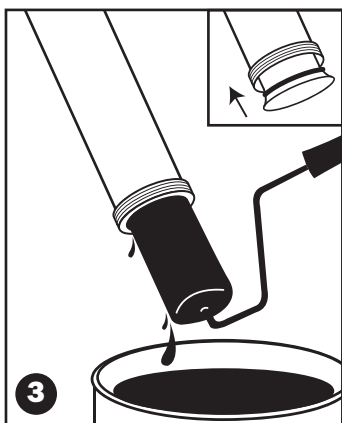

How to use faucet adapter

1. Remove the aerator from the utility, kitchen, or bathroom sink faucet by turning it counter clockwise. (If you must use a wrench or pliers to remove aerator, first wrap tape or cloth around faucet to protect the finish.)
2. Install faucet adapter by threading it into the faucet opening. For faucets that have threads inside the faucet opening, insert the small end of the adapter. (see figure 1)
3. If the threads are on the outside of the faucet, unscrew and remove the small end of the adapter before threading the adapter into place.
4. Once the adapter is in place, the hose can easily be connected to the faucet for use with the Rejuv-a-Roller. (see figure 2)

For Cleaning 3/8" To 3/4" Nap Rollers

1. Unscrew pressure head.
 2. Make sure sleeve provided is inserted into main housing AND pushed inside firmly. (see figure 3 inset)
 3. Push paint covered roller into sleeve. (If roller is soaking wet to where it is oozing paint turn housing upside down as you are inserting roller squeezing excess paint back in to the pan or can saving the extra paint - see figure 3).
 4. Remove roller handle.
 5. Simply push the plug into the roller to seal. (see figure 4)
 6. Thread pressure head onto main housing. (see figure 5)
 7. **Turn on hot and cold water gradually until water starts to exit below, then you can turn water on full blast.** (see figure 6)
 8. When the water comes out clear, let it run for an additional 30 seconds.
 9. Unscrew pressure head off and take out the roller.
 10. Shake off excess water from roller and it is ready to use again or store away.
- Note:** If 3/4" roller has very thick and dense nap you may clean without using sleeve as long as the roller fits snugly into the Rejuv-a-Roller!

For Cleaning 1" To 1-1/2" Nap Rollers

1. Unscrew pressure head.
2. Take sleeve provided out of main housing and set aside.
3. Push paint covered roller into main housing. (If roller is soaking wet to where it is oozing paint turn housing upside down as you are inserting roller squeezing excess paint back in to the pan or can saving the extra paint - see figure 3).
4. Remove roller handle.
5. Simply push the plug into the roller to seal. (see figure 4)
6. Thread pressure head onto main housing. (see figure 5)
7. **Turn on hot and cold water gradually until water starts to exit below, then you can turn water on full blast.** (see figure 6)
8. When the water comes out clear, let it run for an additional 30 seconds.
9. Unscrew pressure head off and take out roller.
10. Shake off excess water from roller and it is ready to use again or store away.

Helpful Hints

- If roller is difficult to remove from main housing after cleaning simply re-insert roller handle 1/3 of the way in and pull out at an angle.
- A small amount of dish soap can be added into main housing after Step 8, then run water through again to help clean the roller even more.

For cleaning brushes, edgers, pans & other uses

1. Unscrew pressure head off main housing and use independently with hose provided. (see figure 3)
2. Consumer is responsible for checking the local codes for proper paint disposal.
3. The time it takes to clean a roller is determined by water volume and pressure and that may vary from house to house.



Warnings: Please read all instructions before attempting to use the Rejuv-a-Roller • Always wear eye protection • Check local codes for proper paint disposal • **Do not use with oil-based paint** • Too hot of water may damage roller sleeve • Test drainage in sink prior to using Rejuv-a-Roller

* Shorter length rollers may take longer to clean.